

DC25 MA - DC65 MA

Technical characteristics:

Thickness < 3 mm (0,12") according to material

Burr-free tube squaring and edge breaking machine used after a band saw cut or on electropolished tubes. Ideal tool to face a band saw cut before automatic welding

18 V Drill / Driver motor:

- 220-240 V ~ 50 / 60Hz or 100-120V ~ 60Hz
- High rotation torque
- Rugged reduction housing which allows heat dissipation and optimal durability
- Come with two 18V Li-Power, 5.2 Ah batteries and a fast battery charger
- 2 mechanical speeds + electric speed variator :

Speed 1 : 0-500 tr/min (rpm)

Speed 2 : 0-1700 tr/min (rpm)

All motors are supplied in their own individual cases, including the necessary tools

DC25

There are two mounting positions for the blade to cover the range of diameter.



DC65

Adjustment of the tool support by sliding: allows easy adjustment according to diameter and optimization of tool wear.



- 30° and 45° outside bevel possible with optional tool holder
- Facing and bevelling in one operation
- Possibility to use two tools simultaneously

DC65 : Flexible use



	Product Code	Facing machine for the following diameters (mm)	Net weight	Minimal straight length of tube	Dimensions (HxLxI in mm)
120 V Drill / Driver	DC25-MA1	Ø3 - Ø25.4 0.1 - 1"	2.5 kg	With standard jaws : 9mm (0.354") With micro-fit jaws : 5mm (0,196")	285 x 220 x 75
	DC65-MA1	Ø3 - Ø63.5 0.1 - 2.5"	5.5 kg	With standard jaws : 10mm (0,393")	140 x 325 x 250
230 V Drill / Driver	DC25-MA2	Ø3 - Ø25.4 0.1 - 1"	2.5 kg	With standard jaws : 9mm (0.354") With micro-fit jaws : 5mm (0,196")	285 x 220 x 75
	DC65-MA2	Ø3 - Ø63.5 0.1 - 2.5"	5.5 kg	With standard jaws : 10mm (0,393")	140 x 325 x 250



DC25 MS - DC65 MS

High quality blades

HSS TIALN blade
Reversible,
two cutting edges



Clamping shells

Stainless steel molded
jaws



Easy adjustment

Indexable wrist and
wide opening with
spring

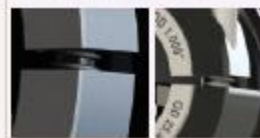

Mains motor, 1100 W

- 2 mechanical speeds + electric speed variator
- Special handy design
- Work without return shock
- Rugged reduction housing which allows heat dissipation and optimal durability

AXXAIR

INNOVATIVE ORBITAL SOLUTIONS

Accurate manual advance

Graduated vernier
scale



Easy set up of the tube

Large opening and
pivot clamping



Delivered in an anti-shock case

Water- and dustproof



Facing range

DC25-MS	ø3 - ø25.4 mm 0.1 - 1"
DC65-MS	ø3 - ø63.5 mm 0.1 - 2.5"



DC25 MS - DC65 MS

Technical characteristics:

Thickness < 3 mm (0,12") according to material

Burr-free tube squaring and edge breaking machine used after a band saw cut or on electropolished tubes. Ideal tool to face a band saw cut before automatic welding

Mains motor 1100 W:

- 220-240 V ~ 50 / 60Hz or
- 100-120V ~ 60Hz
- High rotation torque
- Two speed gearbox with variable speed drive
- High quality speed controller
- Immobilizer protection
- Housing reducer in cast aluminum

- 2 mechanical speeds + electric speed variator :
- Speed 1 : 0-1000 tr/min (rpm)
- Speed 2 : 0-3100 tr/min (rpm)

All motors are supplied in their own individual cases, including the necessary tools

DC25

There are two mounting positions for the blade to cover the range of diameter.



DC65

Adjustment of the tool support by sliding: allows easy adjustment according to diameter and optimization of tool wear.

- 30° and 45° outside bevel possible with optional tool holder
- Facing and bevelling in one operation
- Possibility to use two tools simultaneously



DC65 : Flexible use



	Product Code	Facing machine for the following diameters (in mm)	Net weight	Minimal straight length of tube	Dimensions (HxLxI in mm)
1100W 120 V	DC25-MS1	Ø3 - Ø25.4 0.1 - 1"	2.5 kg	With standard jaws : 9mm (0.354") With micro-fit jaws : 5mm (0,196")	300x 370 x 76
Mains motor	DC65-MS1	Ø3 - Ø63.5 0.1 - 2.5"	5.5 kg	With standard jaws : 10mm (0,393")	132 x 345 x 340
1100W 230 V	DC25-MS2	Ø3 - Ø25.4 0.1 - 1"	2.5 kg	With standard jaws : 9mm (0.354") With micro-fit jaws : 5mm (0,196")	300x 370 x 76
Mains motor	DC65-MS2	Ø3 - Ø63.5 0.1 - 2.5"	5.5 kg	With standard jaws : 10mm (0,393")	132 x 345 x 340



Join **experience**



DC115-AM - 221-AM**AXXAIR**
INNOVATIVE ORBITAL SOLUTIONS**Clamping shells**DC115 : Stainless steel
clamping jawsDC221 : Aluminium
clamping jaws**Accurate manual
advance**0.1 mm steps
(0,0393")**30° and 45° outside
bevel**possible with
optional tool holder**Easy set up of of tube**1 set of jaws for each
diameter**Multi-tools**Possibility to use
two (DC115)
or three (DC221)
tools simultaneouslySliding adjustment of
tool holder offers easy
diameter change and
optimal tip wearing**Delivered in a
wooden box****1100 W motor**Motor mains 1100W with large
speed range (2 gears)Screw and wheel drive to
optimize the speed range and
eliminate vibrations**High quality blades**HSS TIALN
blade.Reversible,
two cutting edges**Facing range**

DC115 AM	ø12 - ø115 mm 0.5" - 4.5"
DC221 AM	ø50 - ø220 mm 2" - 8.5"